

SECTION 25 PLAN  
OF  
SECTIONAL TITLE SCHEME "THE  
MOORINGS"  
SITUATE ON ERF 1389 KNYSNA IN  
THE MUNICIPALITY AND  
ADMINISTRATIVE DISTRICT OF  
KNYSNA

SCALE 1 : 750

TO BE READ IN CONJUNCTION WITH PLANS:  
AS PREPARED BY "THREE" ARCHITECTS

- LEGEND :
- 1. (C.P.) denotes common property
  - 2. (E U) denoted exclusive use area
  - 3. All parking bays are exclusive use area's to be allocated by developer
  - 4. G1 - G3 denotes Garden Exclusive use area

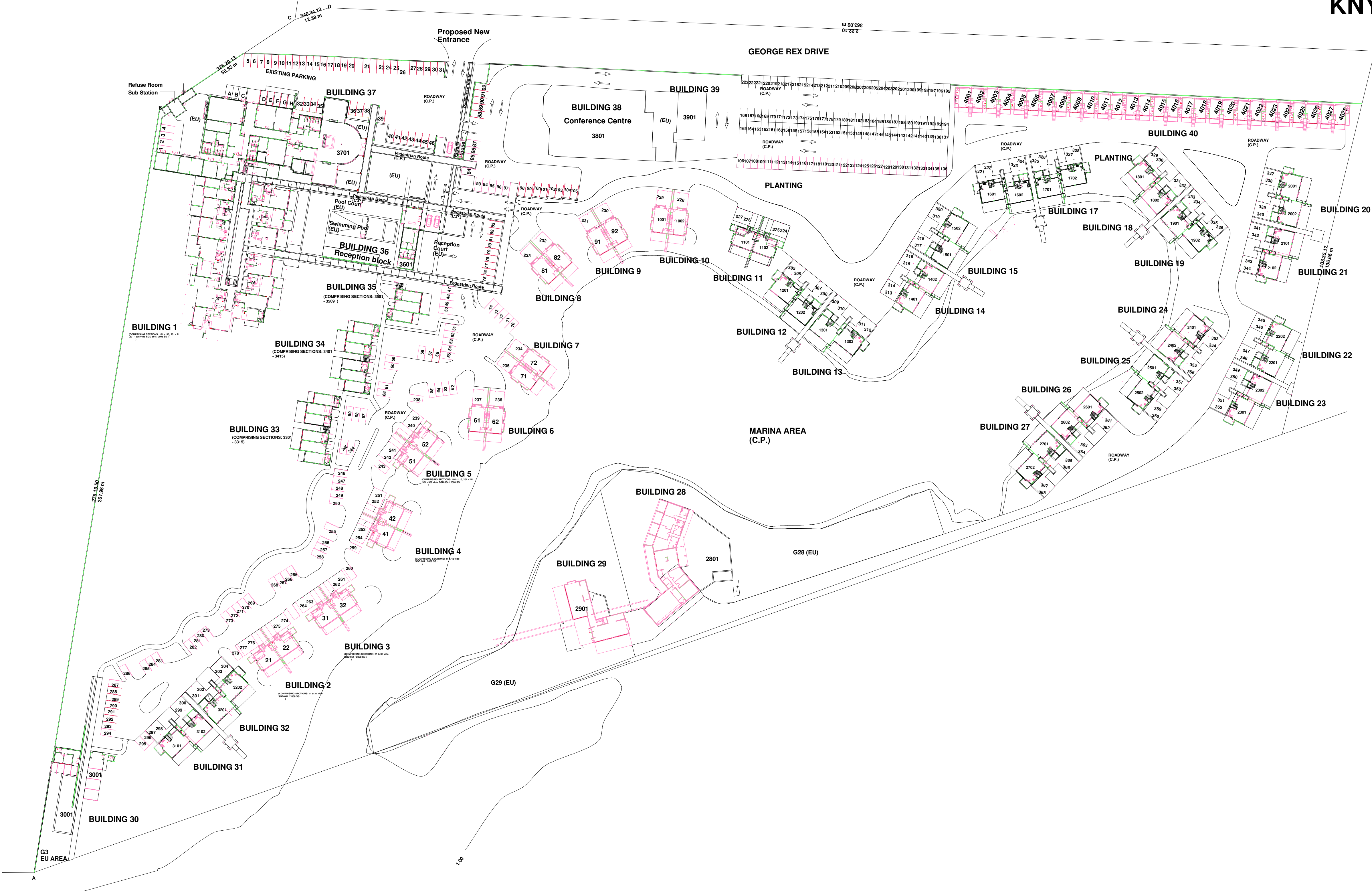

- LEGEND :
- 1. (C.P.) denotes common property
  - 2. (E U) denoted exclusive use area
  - 3. All parking bays are exclusive use area's to be allocated by developer
  - 4. G1 - G3 denotes Garden Exclusive use area

three

\*URBAN DESIGN  
\*ARCHITECTURE  
\*INTERIORS

PHONE 021 465 4800 | FAX 021 465 4865 | CELL 082 305 9001  
E-MAIL: [info@threearchitects.co.za](mailto:info@threearchitects.co.za)